

REDMOND

Air purifier
RAC-3708



User manual

CONTENTS

IMPORTANT SAFEGUARDS.....	5
Technical Specifications	6
Package Includes	6
Parts of Appliance.....	6
Control panel	6
I. PRIOR TO FIRST USE	6
II. OPERATION	6
III. CLEANING AND MAINTENANCE	7
General guidelines	7
Filter replacement	7
Storage and transportation	7
Keep the device package away from water and other liquids.....	7
IV. BEFORE CONTACTING SERVICE CENTER.....	7

Manufacturer: "Power Point Inc Limited" №1202 Hai Yun Ge (B1) Lin Hai Shan Zhuang Xia-meilin Futian Shenzhen, China, 518049. Under license of REDMOND®
Изготовитель: «Пауэр Пойнт Инк. Лимитед» №1202 Хай Юн Гэ (B1) Лин Хай Шан Чжуан Сямейлин Футьян, Шеньжень, Китай, 518049. По лицензии REDMOND®
Виробник: «Пауер Пойнт Инк. Лимітед» № 1202 Хай Юн Ге (B1) Лін Хай Шан Чжуан Сямейлін Футьян, Шеньжень, Китай, 518049. За ліцензією REDMOND®

Importer (EU): SIA "SPILVA TRADING" Address: Jelgava, Meiju cels 43 – 62, LV-3007 Reg. Nr. 43603078598. **BA** Uvoznik i distributer za Bosnu i Hercegovinu: ASBIS d.o.o., Dzemala Bijedica 162, 71 000, Sarajevo, Bosna i Hercegovina. Tel: +387 33 770 200, e-mail: prodaja@asbis.ba, www.asbis.ba. **BG** Вносител: АСБИС България ЕООД И.Н.: BG121655056 Адрес: София, бул. Искърско шосе 7, ТЦ Европа, срп. 3. Тел.: 02/4284111, www.asbis.bg. **CZ** Dovoze: ASBIS CZ spol. s r.o. Obchodní 103, 251 01 Cestlice, Praha – vychod, Praha, Czech Republic. Tel: +420 272 117 111, www.asbis.cz. **HU** Importőr: ASBIS Magyarország Kft., H-1135, Budapest, Reitter Ferenc utca 46-48. Tel.: +36 1 236-1000, Fax: +36 1 236-1010, www.asbis.hu. **PL** ASBIS POLAND SP Z O.O., Ul. Krasnowolska 17 A, 02-849, Warszawa. Tel +48 22 33 71 510, www.asbis.pl. **RO** Importator: ASBIS Romania SRL, Splaiul Independentei 319, SEMA PARC, Obiectiv 5, Etaj 2, Sector 6, Bucuresti, 062650, Romania. Tel +40 21 337 1099, www.asbis.ro. **RU** Импортёр в России: ООО «ИЛОТ», 198099, г. Санкт-Петербург, ул. Промышленная, д. 38, к. 2, лит. А, тел.: +7 (812) 740-16-30. **SK** Importér/distribútor pre SR: ASBIS SK spol. s r.o., Tuňovska 33, 831 06, Bratislava. Tel: +440-2-32165111, www.online.asbis.sk. **RS** Uvoznik i servis za Republiku Srbiju: ASBIS d.o.o., Cara Dušana 205A, 11080 Zemun, Beograd. Tel: +381 11 310 77 00, www.asbis.rs. **LV** Izplatītājs: SIA „ASBIS BALTICS”; Latvia, Riga, Bauskas iela 58A-15, LV-1004; Tel.: +371 66047820, e-mail: sales@asbis.lv, www.asbis.lv. **UA** Імпортер в Україні: ТОВ ПЛІ «АСБІС-УКРАЇНА», 03061, м. Київ, вул. Газова, будинок 30. Тел. +38 044 455 44 11, www.asbis.ua. **SL** Distributer, dajalec garancije in servis za Slovenijo, Asbis d.o.o., Brodišče 15, 1236 Irzin; Tel: + 386 (0) 590 79 927; e-mail: infosales@asbis.si; www.asbis.si. **HR** ASBIS-CR d.o.o.; Slavonska avenija, 24/6 -1 kat; 10000, Zagreb, Croatia; Tel: + 385 1 600 9900, e-mail: prodaja@asbis.hr; www.asbis.hr. **EE** Maaletooja: SIA „ASBIS BALTICS”; Turi 10c, 11313, Tallinn, Estonia; Tel.: + 372 66047815, e-mail: sales@asbis.ee; www.asbis.ee. **LT** Importuotojas: SIA „ASBIS BALTICS”; Ateities g. 25B, 06326, Vilnius, Lietuva; Tel.: +370 66047814, e-mail: sales@asbis.lt; www.asbis.lt. **CY** Importer Cyprus: ASBIS Kypros Limited; 26, Spyrou Kyprianou Str, 4040, Germasogeia, Limassol, Cyprus. Tel: +357 25 257 350; Fax: +357 25 322 432, e-mail: info@asbis.com.cy; www.asbis.com.cy

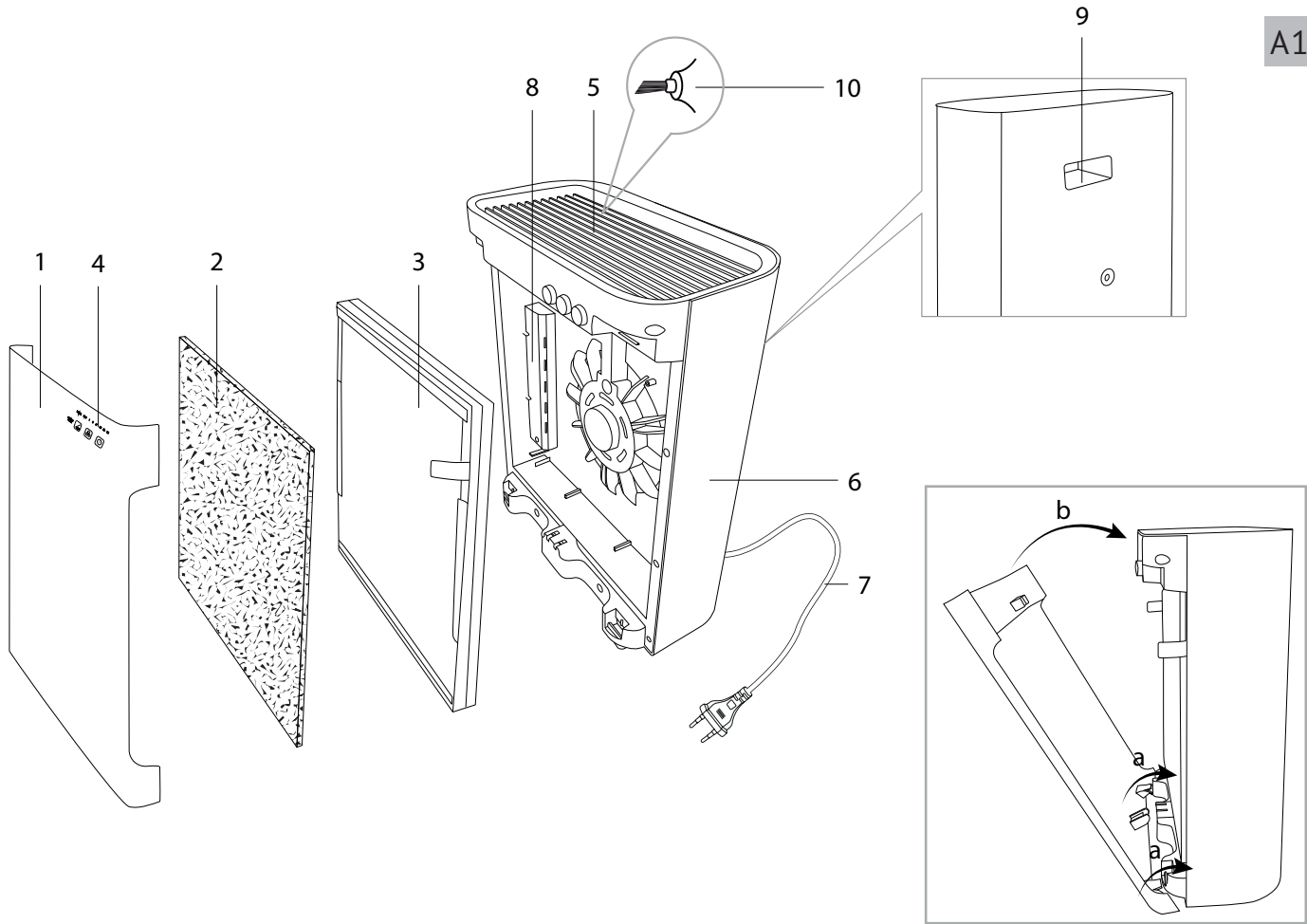

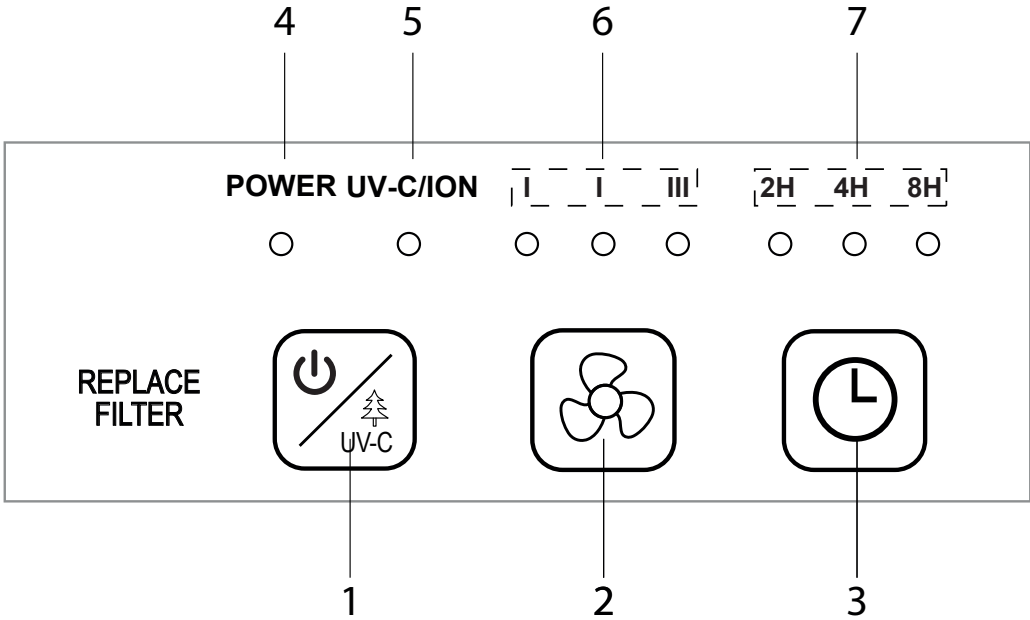



 Read the user manual carefully and keep it as a reference book. Proper use of the appliance will significantly prolong its life.

The safety measures and instructions contained in this manual do not cover all possible situations that may arise during the operation of the appliance. When operating the device the user should be guided by common sense, be cautious and attentive.

IMPORTANT SAFEGUARDS

- The manufacturer is not responsible for any failures arising from the use of this product in a manner inconsistent with the technical or safety standards.
 - This appliance is intended to be used for nonindustrial use in household and similar spheres of application. Industrial application or any other misuse will be regarded as violation of proper service conditions. Should this happen, manufacturer is not responsible for possible consequences.
 - Before installing the appliance, check that the device voltage corresponds with the supply voltage in your home (refer to rating plate or technical data).
 - While using the extension cord, make sure that its voltage is the same as specified on the device. Using different voltage may result in a fire or other accident, causing appliance damage or short circuit.
 - Always unplug the device after use, before cleaning or moving. Never handle the plug with wet hands. Do not pull the power cord to disconnect from the outlet; instead, grasp the plug and pull to disconnect.
 - Use the appliance for its intended purpose only. Otherwise it will be considered as misuse.
 - Keep the power cord away from hot surfaces (gas or electric ovens) or sharp edges. Do not let the cord hang over edge of a table or a counter.
-  **REMEMBER:** *damaging the cord may lead to a failure that will not be covered by the warranty. If the power cord is damaged, it must be replaced by the manufacturer, after-sales service or similar qualified personnel to avoid possible danger.*
- Do not operate the appliance outdoors, to prevent water or any foreign object or insect from getting into the device. Doing so may result in serious damage of the appliance.
 - Always unplug the device before cleaning. Follow cleaning and general maintenance guidelines when cleaning the unit.
-  **DO NOT immerse the device in water or wash it under running water!**
- This appliance can be used by children aged from 8 years and above and persons with reduced physical, sensory or mental capabilities or lack of experience and knowledge if they have been given supervision or instruction concerning use of the appliance in a safe way and understand the hazards involved. Children shall not play with the appliance. Keep the appliance and its cord out of reach of children aged less than 8 years. Cleaning and user maintenance shall not be made by children without supervision.
 - Keep the packaging (film, foam plastic and other) out of reach of children as they may choke on them.
 - No modifications or adjustments to the product are allowed. All the repairs should be carried out by an authorized service center. Failure to do so may result in device and property damage or injury.
-  **CAUTION!** *Do not use the appliance in case of any malfunctions.*

Technical Specifications

General Specifications

Model.....	RAC-3708
Voltage.....	220-240 V, 50 Hz
Rated power.....	55 W
Electrical safety.....	class II
Control panel.....	touch
Indication.....	LED
Disconnecting timer.....	up to 8 hours
Number of blowing speeds.....	3
Overall dimensions.....	324 × 409 × 162 mm
Net weight.....	4 kg
Power cord length.....	1.8 m

Operational efficiency

Recommended floor area.....	up to 40 m ²
Multi-level cleaning system:	

- Pre-filter (retains large particles of dust and allergens)
- Active carbon filter (keeps small particles of dust and allergens, smoke, pollen, etc.)
- HEPA-filter H13 (absorbs formaldehyde, benzene and other harmful gases)
- UV lamp (disinfects the air, removes odours)

Ionization.....	available
Air purification efficiency.....	99.95%
Negative ion density.....	≥3 000 000 u/cm ³
Maximum air exchange.....	215 m ³ /h
Maximum noise level.....	48 dB
Auto shut-off.....	when removing the lid

Package Includes

Air purifier.....	1 pc.
User manual.....	1 pc.
Service book.....	1 pc.

Manufacturer reserves the right to make any modifications to design, packaging, or technical specifications of the product without prior notice. The specification allows an error of ±10%

Parts of Appliance (scheme **A1**, p. 3)

1. Appliance lid
2. Pre-filter
3. HEPA-filter H13 + active carbon filter
4. Touch control panel
5. Openings for purified air output

6. Housing
7. Power cord
8. UV lamp
9. Carrying handle
10. Ionizator

Control panel (scheme **A2**, p. 4)

1. On/off button of the device and UV lamp
2. The button for adjusting the blowing speed
3. The button for setting the device sleep timer
4. Operation indicator
5. UV lamp operation and ionization functions indicator
6. Blowing speed indicator
7. Indicator of sleep timer values

I. PRIOR TO FIRST USE

Carefully remove the unit and its accessories from the packaging. Dispose of all packaging materials and promotional stickers.



 *Keep all warning labels, warning stickers (if any), and the serial number identification label located on the housing.*

After transportation or storage at low temperatures allow the appliance to stay at room temperature for at least 2 hours before use.

Completely unwind the power cord. Wipe the housing with a damp cloth. Ensure that outer and visible inner parts of the appliance are not damaged, do not have chips and other defects. Make sure that all parts of the appliance are installed correctly.

II. OPERATION

1. Fix the appliance to firm, level and flat location. Selecting the location place for the air purifier, follow the recommendations listed below:
 - do not fix the air filter close to direct heat source;
 - locate the appliance at least 25-30 cm from interior design items and 1 m from TV and computer equipment.
2. Press  button, to switch the appliance:
 - the first press – switch on the appliance (the operation indicator will light up);
 - the second press – switch on UV lamp and ionization function (indicator of the UV lamp and the ionization function will light up);

- the third press – switch off UV lamp and ionization function (indicator of the UV lamp and the ionization function will turn off);
 - the fourth press – switch off the appliance (all indicators will turn off).
3. By pressing the  button, set the required level of air purification intensity from I to III: minimum (I), medium (II) or maximum (III). Switching is performed circle-wise. The set speed indicator will be lit.
 4. Press the  button to set the appliance sleep timer:
 - one click – 2 hours;
 - two clicks – 4 hours;
 - three clicks – 6 hours;
 - four clicks - timer deactivated.

The set value indicator will be lit. After the selected period of time, the appliance will automatically turn off.

5. When you finish using the appliance, turn it off and unplug it from the mains.

III. CLEANING AND MAINTENANCE

General guidelines

Clean the appliance when polluted. Before cleaning the appliance, ensure it is unplugged.

STOP *DO NOT immerse the appliance in water or wash under running water!*

DO NOT use a sponge or tissue with hard or abrasive surface or abrasive pastes. Do not use any chemically aggressive substances.

Clean the housing with a soft cloth or sponge. You can use mild soap for cleaning. We recommend you to wipe the surface dry to avoid water stains and residues on the housing. Rinse the pre-filter with warm water at least once a month.

Filter replacement

Approximate service life of HEPA filter is 2000 hours. When the filter resource is depleted, the operation indicator will flash. To replace the filter, remove the old one and install a new one. After replacing the filter, press and hold the  button for a few seconds until the indicator stops flashing.

Storage and transportation

Before repeated operation or storage completely dry all parts of the appliance. Store the assembled appliance in a dry, ventilated place away from heating appliances and direct sunlight. During transportation and storage, do not expose the device to mechanical stress, that may lead to damage of the device and/or violation of the package integrity.

Keep the device package away from water and other liquids.

IV. BEFORE CONTACTING SERVICE CENTER

Problem	Possible cause	Solution
Appliance does not switch on	Power cord is not connected to an electrical outlet	Connect to an electrical outlet. Verify that outlet is functioning properly
	Faulty electrical outlet	Plug the appliance into a serviceable outlet
	Appliance lid detached	Put the appliance lid into place

i *In case you didn't manage to eliminate the defects, please, refer to the authorized service centre.*



Environmentally friendly disposal (WEEE)

The packaging, user manual and the device itself shall be taken to the applicable collection point for the recycling of electrical and electronic equipment. Do not throw away the electronic waste to help protect the environment.

Old appliances must not be disposed with other household waste but must be collected separately. Municipal disposal of recyclable wastes is free of charge. The owners of old appliances are required to bring it to a waste facility centre. With this little extra effort, you can help to ensure that valuable raw materials are recycled and pollutants are treated as appropriate.

This appliance is labelled in accordance with European Directive 2012/19/EU – concerning used electrical and electronic appliances (waste electrical and electronic equipment WEEE). The guideline determines the framework for the return and recycling of used appliances as applicable throughout the EU.

www.redmond.company
www.multivarka.pro
www.store.redmond.company
www.smartredmond.com
Made in China

RAC-3708-ENG-UM-1